



KEND HOSPITAL HARDWARE AND MOT SYSTEMS

KAD 1300 Automatic Sliding System



KAD-1300

- Capacity : 120kg x 1 wing
100kg x 2 wing
- Door Width : 200mm - 2.000mm

KAD-1500

- Capacity : 150kg x 1 wing
130kg x 2 wing
- Door Width : 200mm - 2.000mm

CISA Floor Hinge



CISA 60231-04

- Max. door width : 1000 mm
- Max. door weight : 100 kg
- Hold open 90°

CISA 60241-05

- Max. door width : 1200 mm
- Max. door weight : 200 kg
- Hold open 90°

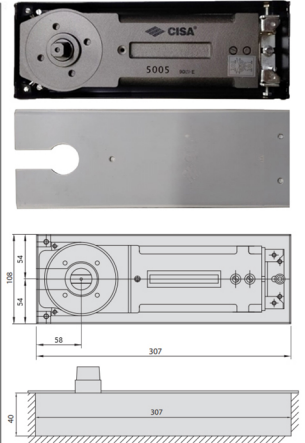
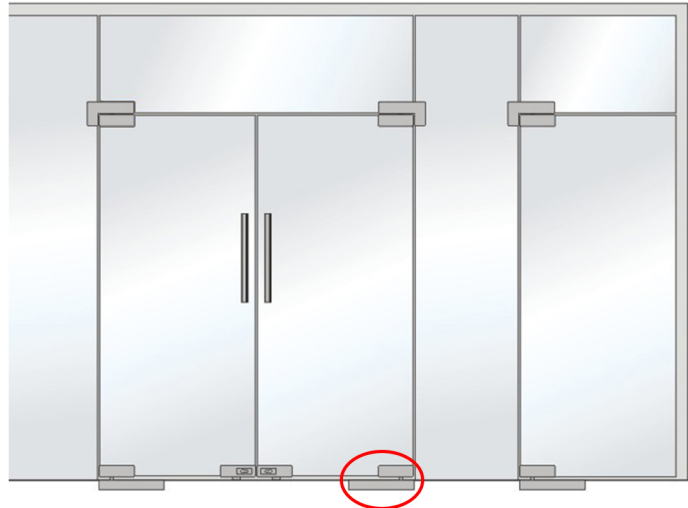

TYPE	HOLD OPEN	Maximum door width		Maximum door weight (kg)	
		Interior (mm)	Exterior (mm)		
60231-04	90°	1100	1000	100	<ul style="list-style-type: none"> Closing speed adjustment sector Closing speed adjustment sector Closing speed adjustment sector
60241-05	90°	1300	1200	200	

AD 300 Door Operator





AD 300

- Hold Open Time : 1 - 30s
- Max Opening Angle : 120°
- Protection Class : IP12D
- Dimension : 515(L) x 95 (H) x 90 (W) mm
- Max door width : 1200mm @ 80kg
- Min door width : 660mm @ 100kg

Micro Wave Sensor

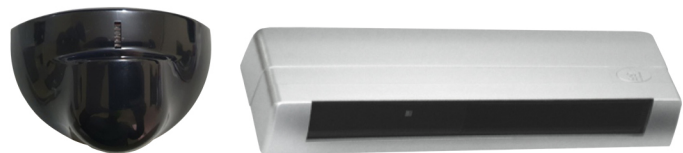

No Touch Sensor



Interlock System (2 Doors and more)

Auto Swing

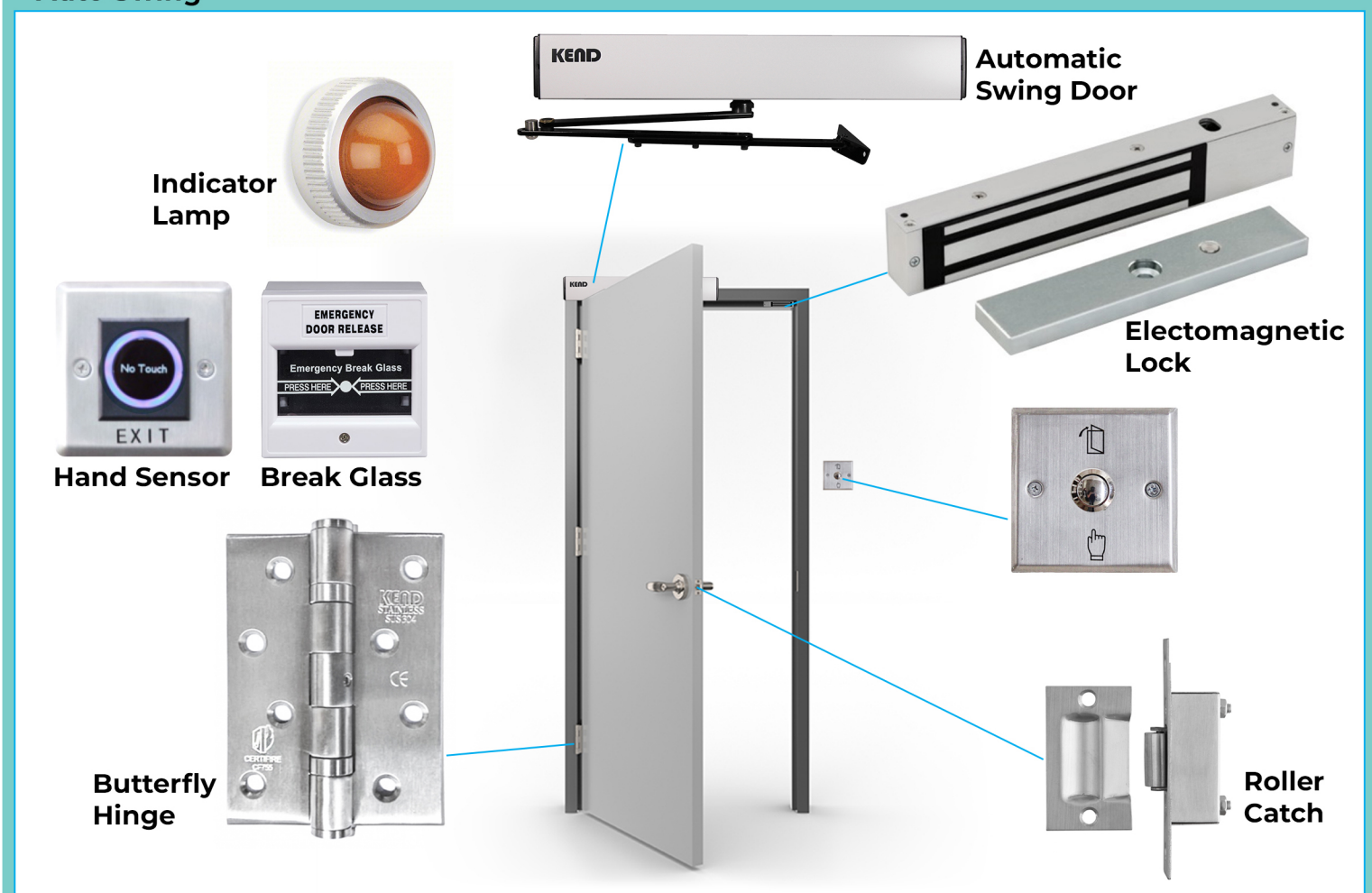



**EXIT BUTTON
TOUCHLESS
EBT-02**



AUTOMATIC SWING DOOR AD-300

Material : stainless steel Finish : US32D



**BREAK GLASS
EBG-01**



ELECTROMAGNETIC LOCK

KEM 28 - 280kg

KEM 50 - 500kg

Material : stainless steel

Finish : US32D



**PUSH BUTTON
EBT-03**



INDICATOR LAMP

IL-01 Red

IL-02 Green

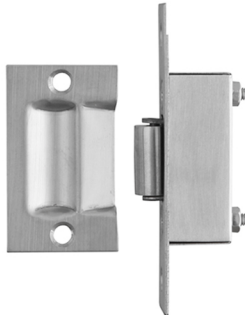

**ROLLER CATCH
RC 75-002**

Material : stainless steel

Finish : US32D



BUTTERFLY HINGE

SEL 0010 4x3x3

Material : stainless steel

Finish : US32D

Armor Plate

Material : stainless steel

Thickness : 1,2mm

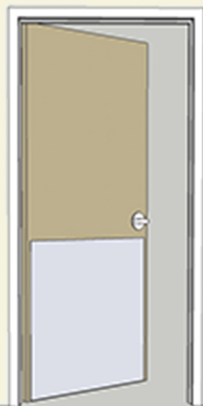

Armor Plate
AP 50-86 (50x86cm)

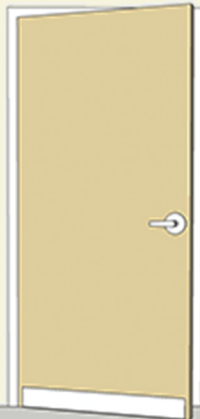

Mop Plate
MP 10-86 (10x86cm)



Strecher Plate
SP 15-86 (15x86cm)

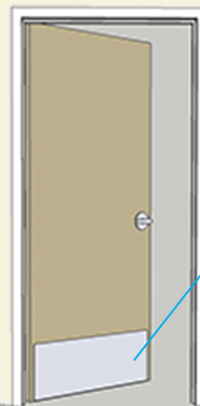

Kick Plate
KP 20-86 (20x86cm)



Emergency Release Door Stop



Emergency Release Door Stop ER 58

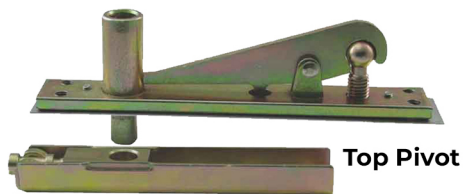

Top Pivot

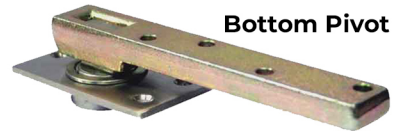

Bottom Pivot

Pivot Hinge CPH 20-500

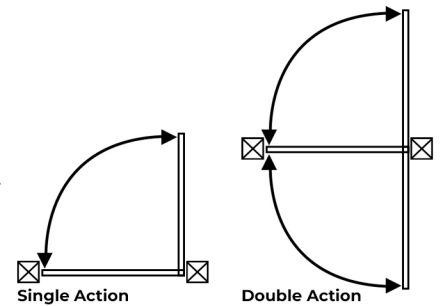
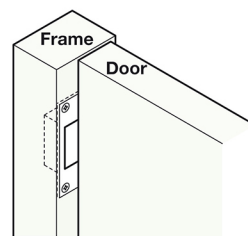
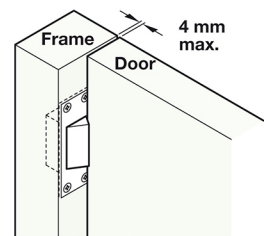

Handicap Toilet Bar



HTB-01



HTB-02

Anti Bacterial Coating - BC



Modular Operating Theater



Sandwich Panel



Sandwich Panel

Panel dinding dan plafond anti-bacterial didesain menggunakan material-material tersertifikasi. Menggunakan lapisan anti-bacterial yang teruji, pemasangan yang cukup mudah dapat mempercepat konstruksi, khusus untuk keperluan bangunan kesehatan, ruangan steril, dan sebagainya. Untuk dinding dan ceiling anti radiasi dapat diperkuat dengan lembar timah hitam 2mm.

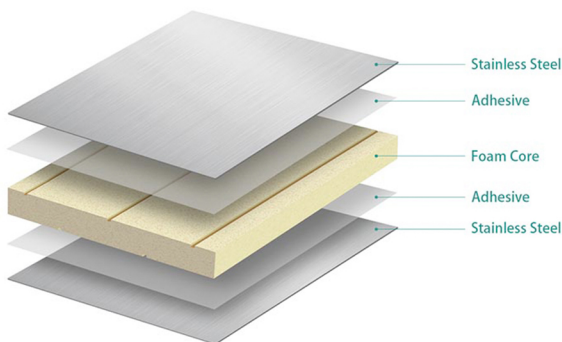

Jenis-Jenis Sandwich Panel **SPPS 50** **SPPS 75**
EPS (Expandable Polystyrene) **SPPS 100** **SPPS 150**
PIR (Polyisocyanurate) Ketebalan : 50, 75, 100, 150mm

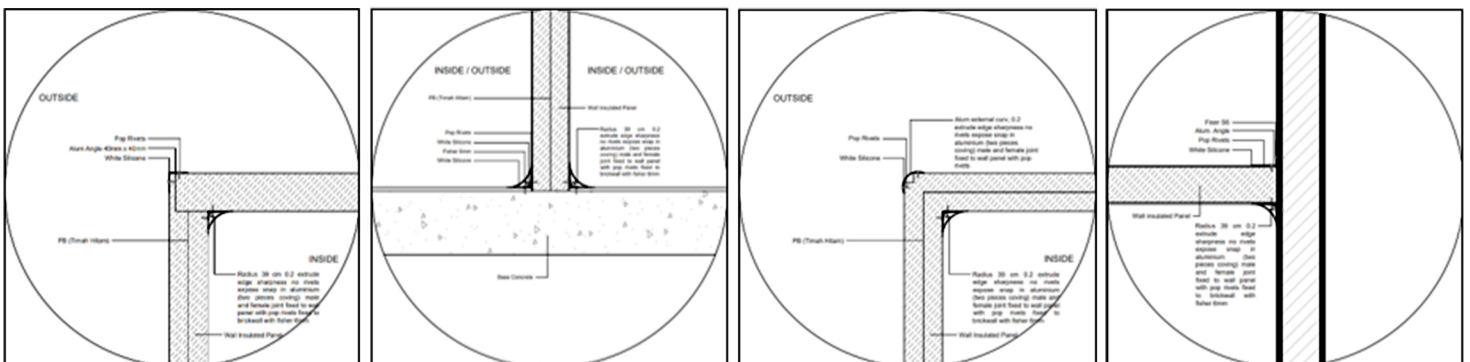

Sambungan antar-panel diinstal dengan lengkungan agar lebih mudah dibersihkan.

Hermetic Door DTH - 200 Seal



Product Description

Usage : Hospital Steril Room

- Prevent outer air to get inside the room or temperature affection
- Smooth operation and obstructed frequent usage due to Deft Volume & high efficient brushless DC motor

Specification

- Set includes : Hermetic Door Frame & Leaf
Handle
Safety Beams
Foot Sensor
- Door Leaf Material : Stainless Steel 304 HL
- Door Leaf Size : 1600mm (m) x 2100mm (h)
- Leaf Thickness : 2mm (inside stainless steel finishing)
- Glass Window Thickness : 15mm (optional)

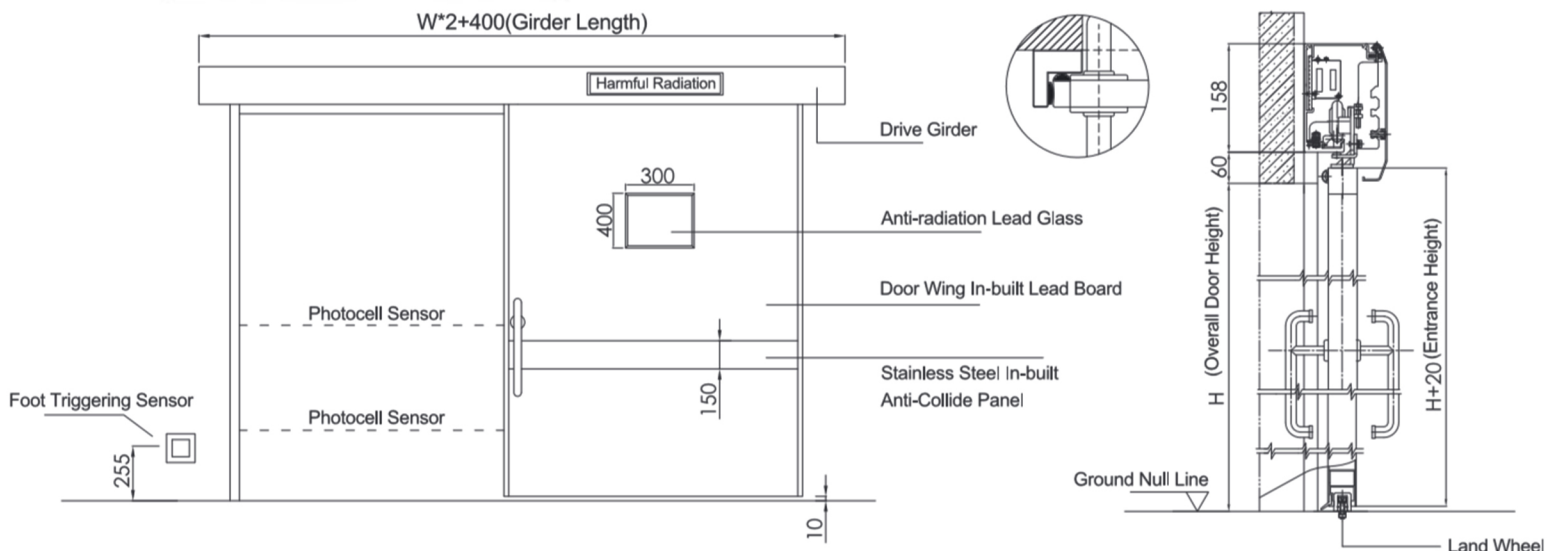

HVAC System

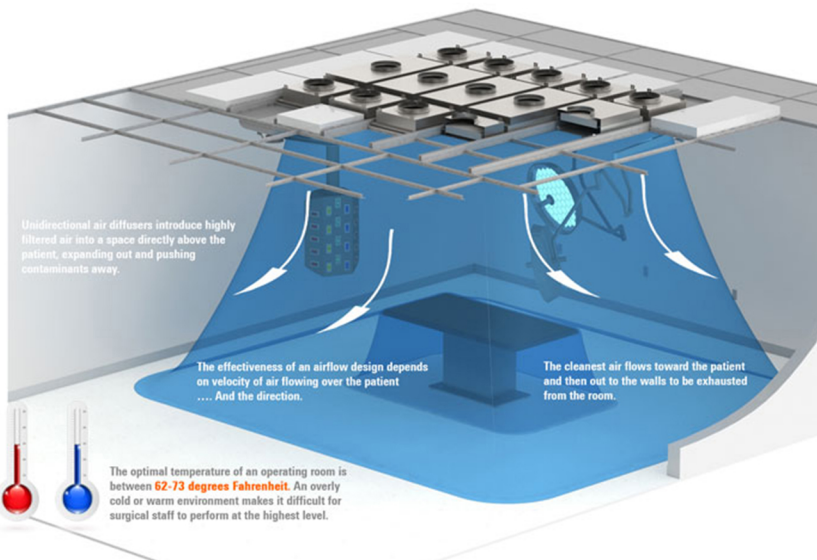

HVAC System (Heating, Ventilation, Air and Conditioning). Berdasarkan Permenkes No. 24 tahun 2016 dan juga mengacu pada FED STD 209E (ISO 14644-1 Cleanrooms Standars 1999) untuk aplikasi rumah sakit yang berada di kelas 100.000 (ISO 8), kelas 10.000 (ISO 7 – ISO 6). Dengan standard suhu 19 – 24° Celcius dan kelembapan 40-60%.

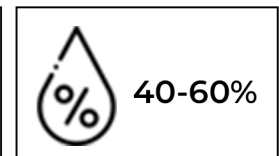
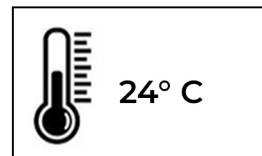



Outdoor Unit

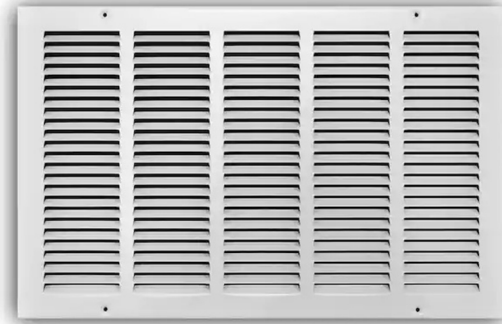

Grille RAG



Air Handling Unit



Unit AC Central



Power Panel

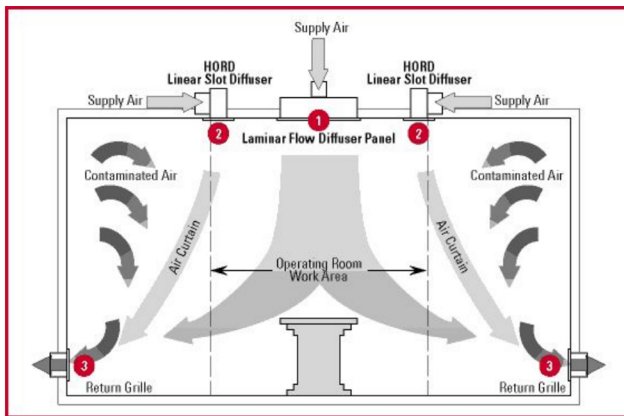

Dengan aliran udara laminar yang sesuai untuk kelas 1.000 & 10.000 yang secara dominan searah dan tidak terhalang sehingga udara tidak terkontaminasi. Pola aliran udara laminar searah biasanya dicapai pada kecepatan 0.46m / detik.

No.	Parameter	Class 10.000	Class 1.000
1.	Air Movement	Laminar	Laminar / Turbulensi
2.	Return Grill	Floor Level	Floor / Ceiling Level
3.	Air Velocity	0,1 to 0,45 m/s	0,25 to 0,5 m/s
4.	ACH (Air Change per Hour)	Minimum 25	Minimum 25

Additional Product



Lemari Penyimpanan

Spesifikasi

- Material : SS Mirror SUS 304 Hollow t. 1,2mm
- Ambalan : Knock Down
- Pintu : Rangka Hollow
- View : Clear Glass t. 6mm
- Ukuran : Custom (Sesuai permintaan customer)
- Pemasangan : Recessed On Wall



Lemari Penyimpanan Hangat

Spesifikasi

- Material : SS Mirror SUS 304 Hollow t. 1,2mm
- Voltage : 220 – 240 V
- Frekuensi : 50 – 60 Hz
- Daya Listrik : 1200 watt
- Refrigerant : R4044A
- Thermocouple : Digital Autonics
- Temperature : 45° C - 60° C
- Lampu Indikator: Pilot Lamp Hijau/Merah
- Dimensi : 600mm (w) x 1400mm (h) x 600mm (t)
- Rack : 3 susun (Knock Down)



Lemari Penyimpanan Dingin

Spesifikasi

- Material : SS Mirror SUS 304 Hollow t. 1,2mm
- Voltage : 220 – 240 V
- Frekuensi : 50 Hz
- Daya Listrik : 700 watt
- Refrigerant : R4044A
- Thermocouple : Digital Autonics
- Temperature : -5° C - 30° C
- Lampu Indikator: Hijau
- Dimensi : 600mm (w) x 1300mm (h) x 600mm (t)
- Rack : 3 susun (Knock Down)

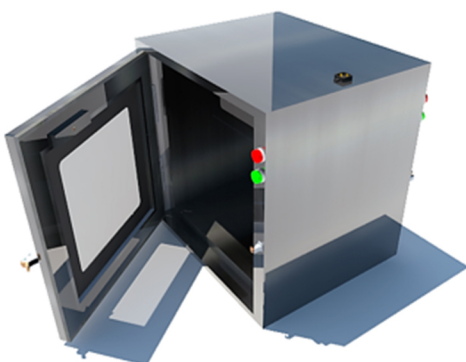

Pass Box

Spesifikasi

- Material : SS SUS 304 Hollow t. 1,2mm
- Voltage : 220 V AC
- Magnet : LCL 60 Kg DC (12 V / 24 V)
- System Power : 705 watt
- Dimensi : 750mm (w) x 700mm (h) x 550mm (t)
- Feature : UV Lamp with timer
- Jendela : t. 6mm di dua sisi
- Observasi Penguncian : System Interlock Magnetic



Scrub Station - ST 05 -1/2/3 (1bay/2bay/3bay)

Spesifikasi

- Double / Triple Bay
- Material : Plat SS SUS 304 Hollow t. 1,2mm
- Plat Kran : Plat SS SUS 304 Hollow t. 1mm
- Dimensi : 800mm (w) x 600mm (l) x 1400-1800mm (h)
- Power Supply : 1200 watt 220 VAC
- Indikator Unit : Power Lamp & Heater Lamp
- UV Lamp : 2 x 30 watt Unites 8 GPM
- Sensor Observasi : Auto Soap & Auto Water
- Penguncian : System Interlock Magnetic
- Heater : 600 watt 220 VAC
- Tube : Pipa SS 304 4 inch
- Adaptor : 24 VDC



Film Viewer - FV 956

Spesifikasi

- Material : Plat Stainless Steel 304 HL t. 1,2mm
- Dimensi : 900mm (w) x 500mm (h) x 60mm (t)
- Kapasitas : 2 NEC / 2 Film
- Illuminator : LED Module 3 Eye (1,5 watt)
- Daya : 190 w / 12 VDC
- Tegangan Input : 220 – 240 VAC
- Operasi : On/Off Switch, Dimmer Illuminator Touch, Timer & Automatic
- Display : White Acrylic 3mm
- Instalasi : Recessed on Wall (Rata Dinding)



LED Lamp - LED 3600

Spesifikasi

- Dimensi : 597mm (l) x 597mm (w)
1197mm (l) x 297mm (w)
- Power : 40 watt
- Tegangan : 220 – 240 VAC
- Color Temperature : White 6500 K
- Lumen Flux : 3600 lm
- Ingress : IP 20 Protection



Surgical Control Panel

Spesifikasi

- Material Panel : Stainless Steel
- Layar : 21,5" Touchscreen
- Processor : ARM Microcontroller
- Analog Input : 6pcs 12 bits 0-10V.
8pcs 12 bits 3,3V
- Analog Output : 18pcs 0-10V
- Digital Input : 8pcs
- Digital Output : 21pcs
- Traceable Parameters :
 - Gas Alarm Indicators
 - Temperature
 - Humidity
 - Differential Pressure
 - Hepa Filter



Timah Hitam

Lembaran Timah Hitam digunakan sebagai pelindung atau pelapis ruang radiologi di rumah sakit. Produk ini terbuat dari timah hitam murni dengan kadar mendekati 100% sehingga memiliki ketahanan terhadap radiasi yang sempurna.

Ukuran :

- 0.8mm
- 1mm
- 1.5mm
- 2mm
- 3mm

KOMPOSISI

No.	Parameter Uji	Satuan	Hasil Uji	Metode Uji
1.	Timah Hitam (Pb)	%	99,48	Gravimetri
2.	Besi (Fe)	%	0,05	Kolometri
3.	Timah Putih (Sn)	%	0,09	Titrimetri
4.	Seng (Zn)	%	0,34	Gravimetri
5.	Mangan (Mn)	%	0	Kolometri



Kaca Anti Radiasi

Kaca Pb / Anti Radiasi bisa digunakan secara efektif di ruang X-Ray / CT-Scan, ruang radioterapi, ruang bedah, laboratorium, pengujian material, dan banyak aplikasi lainnya karena memberikan perlindungan terhadap radiasi. Kaca Pb ini transparan dan memungkinkan operator ruang X-Ray dan CT-Scan untuk memantau proses pengambilan gambar atau terapi radiasi.



Lampu Indikator Ruang OK

Fungsi sebagai indicator bahwa kegiatan operasi dalam ruangan sedang berlangsung.

Lampu : LED warna merah 6 watt / adaptor 1 A
Acrylic : t. 3mm
Ukuran Lampu : 120mm x 200mm x 60mm
Install : Recessed On Wall

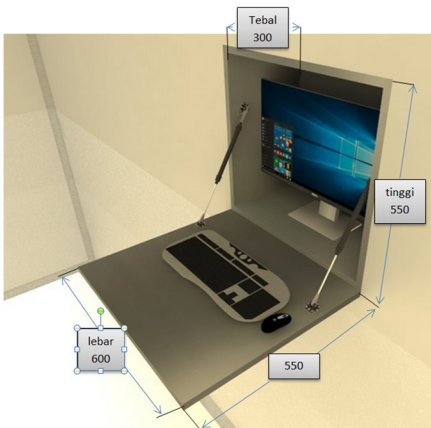

PC Shelf

Berfungsi sebagai meja tulis atau meja laptop yang digunakan apabila diperlukan untuk operasi.

Material : Stainless Steel Hairline thickness 1.2mm
Install : Pemasangan dibenamkan (Recessed On Wall)

Moveable Reducing Sound Partition



Cubicle Toilet

